

Magnetolink® offers a real alternative to fastening with screws and dowel plugs. Smoke alarms can be mounted quickly and cleanly with this magnetic assembly system without using tools. Another advantage is that electricity cables or other lines cannot be damaged during the assembly work. Moreover, it is much easier to change batteries and perform function tests.

The fastening system consists of a self-adhesive ceiling element for fixing to the ceiling and a self-adhesive base element with two magnets for fastening to the smoke alarm.

Please read these instructions carefully. Keep this product out of the reach of children or others who might be at risk. Use this product solely for the intended purpose and in accordance with all the guidelines given in these instructions.

Not suitable for vinyl wallpapers, Styropor®, anti-adhesive coatings, silicon-coated or Teflon-coated surfaces. Not fully suitable for smoke alarms with a diameter of less than 8 cm.

1. Assembling the ceiling element without magnets to the ceiling

Decide on the correct place on the ceiling to install the smoke alarm, as described by the instructions for your smoke alarm.

Ensure that the point of installation on the ceiling is sufficiently stable, dry and free of dust and grease. If necessary, clean it with surgical spirit or a window cleaning agent. All-purpose or bathroom cleaners containing soap are not suitable.

Remember that the adhesive has been designed to make a permanent bond. As it furthermore offers an outstanding instant adhesion, the ceiling element is glued tight immediately after being pressed down and cannot be removed again.

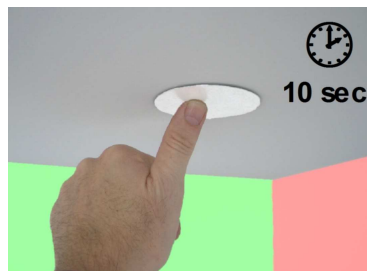
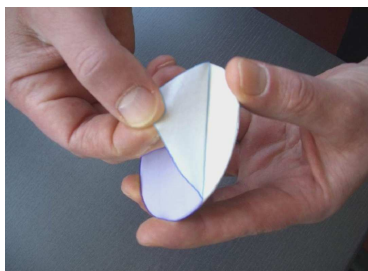

Take the ceiling element (recognisable because it has no magnets

fitted to it), pull the protective foil off and adhere it to the metal plate at the foreseen spot on the ceiling of the room. Press down firmly and hold it for around 10 seconds.

Please note:

- The adhesive offers a good application reliability, whereby the strength of the bond increases over its life.
- The special adhesive has been developed to provide the optimum bond, even on raw and uneven surfaces. Nevertheless, the smoke alarm should not be installed above the head areas of beds.
- Arched or uneven areas can also reduce the adhesive power, such as on panels, varnished, treated or raw wood and on porous or damp plaster.
- Loose surface particles, flaky coats of paint or several layers of paint on the ceiling can likewise reduce adhesion to the ceiling. A glued bond is only ever as strong as its base.

- The ceiling element does not need to be removed during redecorating or painting work, it can be painted over several times without problem.

2. Assembling the base element with magnets to the smoke alarm

First install the battery properly and test the correct functioning of the complete smoke alarm.

Before adhering the magnetic base element (recognisable from the two flat magnets fitted to it), ensure that the assembly plate of the smoke alarm is dry and free of dust and grease. If necessary, clean it with surgical spirit or alcohol. Note that the contact area between the smoke alarm and the base element must be at least 2 cm².

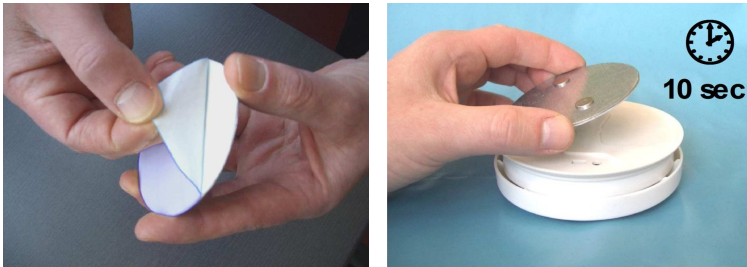

Take the magnetic base element, pull the protective foil off and adhere it to the assembly plate of the smoke alarm. Press down firmly and hold it for at least 10 seconds.

Please note:

- After being adhered, the element may not be removed and subsequently glued down again. Each removal – even though no damage may be apparent – changes the adhesive properties and renders this base element unusable
- If you need to replace the smoke alarm at some time in the future, the old assembly base can be used for the same type of smoke alarm. If the smoke alarm is different, however, it is essential to use the existing ceiling element.
- The odour emitted by the glue after the foil has been pulled off is a production characteristic. It is completely harmless to health and only lingers for a short time.
- Gluing the magnets to the metal plate primarily serves as transport security. Thus even loose and movable magnets ensure secure and reliable fixing to the ceiling.

3. Assembling the smoke alarm to the ceiling



Now simply place the smoke alarm on the ceiling element.

In order to check that the ceiling element is sitting properly, pull the smoke alarm vertically downwards from the ceiling. As the power needed to do this is considerably greater than the gravity working on the smoke alarm, this is a good way to ensure that the ceiling element is properly fixed to the ceiling.

If the smoke alarm needs to be removed from the ceiling in future, do not pull it vertically downwards, but rather slide it sideways out of the ceiling element.

During the monthly function test, press on the base element of the smoke alarm to check that the base element is properly fixed to the assembly plate of the smoke alarm!